



PRE-HUNG, FRAMED ALUMINIUM DOORS

INCLUDING FLAT PACK OPTION

Complete Entrance Door Solution:

- Ready to install
- No need to find frame
- Doors and frames can be colour matched
- Alternative colour options are available

Frame Details

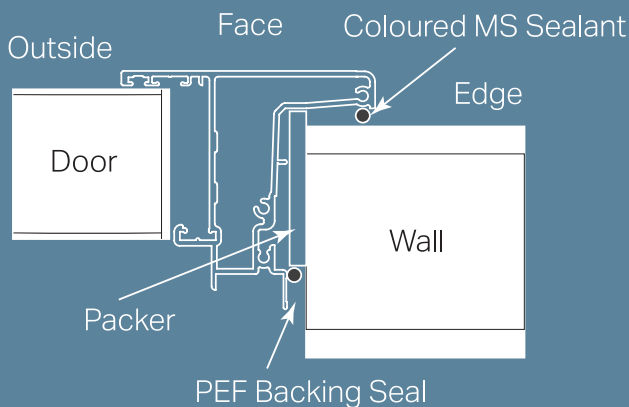

Durable aluminium door

Left or right hung

Powder coated, resistant to scuffing

Complete with aluminium frame

Australia: 1800 681 586
sales@parkwooddoors.com.au
www.parkwooddoors.com.au

EXTERIOR ALUMINIUM DOOR FRAMES 75 & 106MM

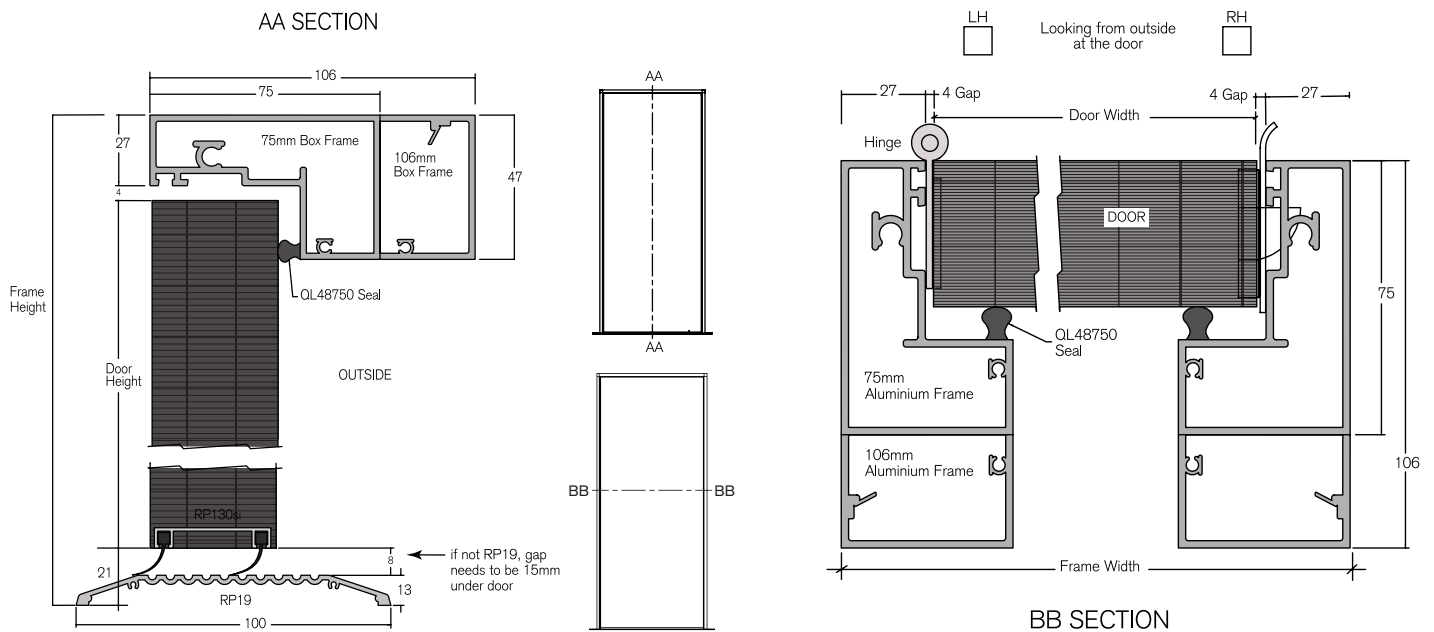

Fixings Included:

AA - Timber x8
Fixing to Wall
Timber



AA - Concrete x8
Fixing to Wall
Concrete



DD x2
Handle &
Escutcheons



CC x2
Lock Body



BB x1
Cylinder



Packers
2mm Thick x16
4mm Thick x8



6mm PEF
Backing Seal



Tools and Equipment Required:

Flat Pack Frame and Door

- 4.5mm drill bit and countersink (for drilling holes in sill)
- No. 2 Square Drive Screwdriver Bit (for 8 gauge screws)
- Battery Drill

Pre-Hung Door and Frame

- 4mm Wood Drill Bit
- 6mm Concrete Drill bit
- No. 3 Square Driver
- Hex Driver
- 1 meter minimum spirit level
- Electric Drill
- MS Coloured Sealant Black
- Timber Revel